

40V Lithium Blower  
Instruction Manual

LB4020001S

LawnMaster®

LITHIUM

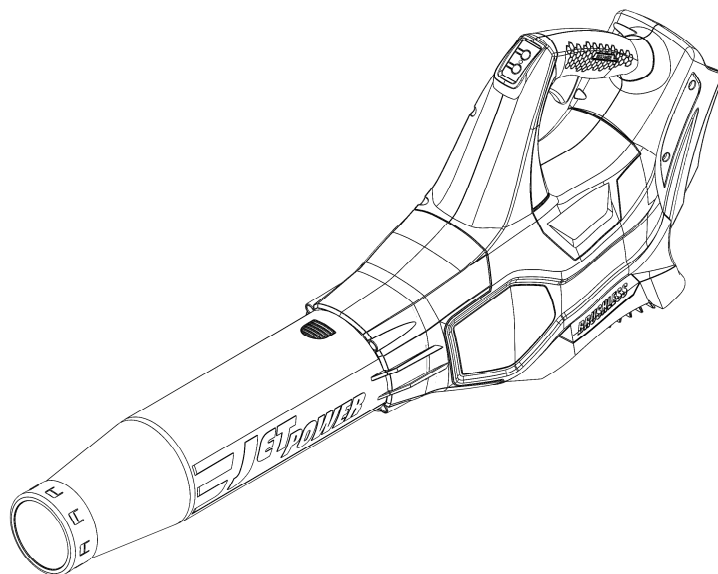

**Important!**

It is essential that you read the instructions in this manual before operating this machine.

All notes and images are subject to technical modification.

Distributed by Steelfort Engineering Ltd



---

# READ FIRST BEFORE USE!

## LawnMaster Lithium Battery Instructions

1. Battery must be fully charged before initial use.
2. Never let the battery discharge below two bars on the battery indicator light- discharging below two bars may cause damage to the battery.
3. Do not continue use if machine stops - fully recharge battery first if below two bar indicator. If above the two bar minimum assess the tool for potential obstructions.
4. We recommend to fully recharge the battery immediately after every use. Allow the battery to cool for at least 15 minutes before recharging.
5. Do not store for a long period without fully recharging battery.
6. Check battery temperature . If above 38°C let battery rest and cool.

Lithium batteries do not need to be fully discharged before recharging.

---

Fig. 1

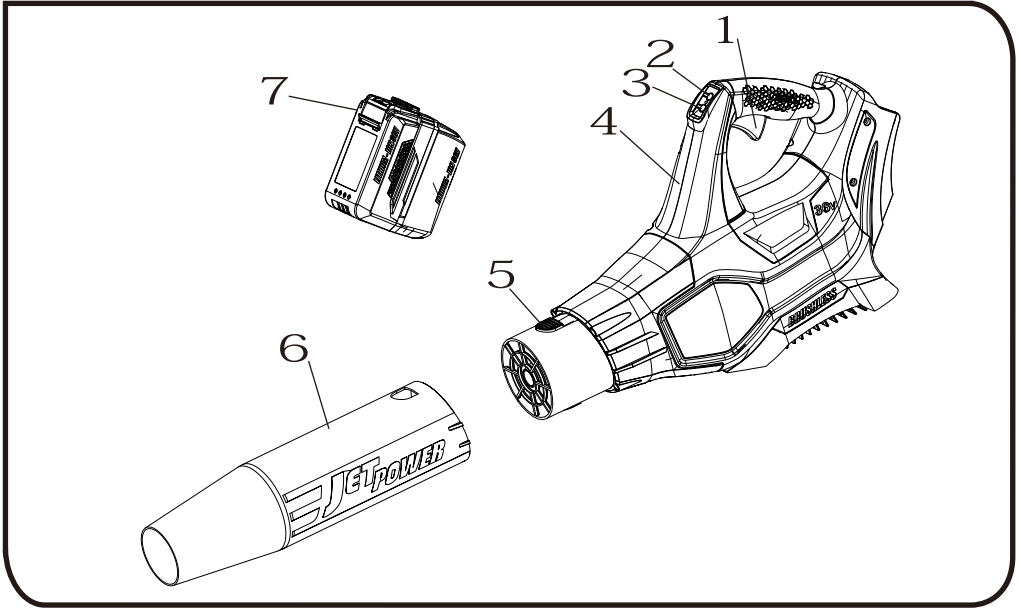

Fig. 2

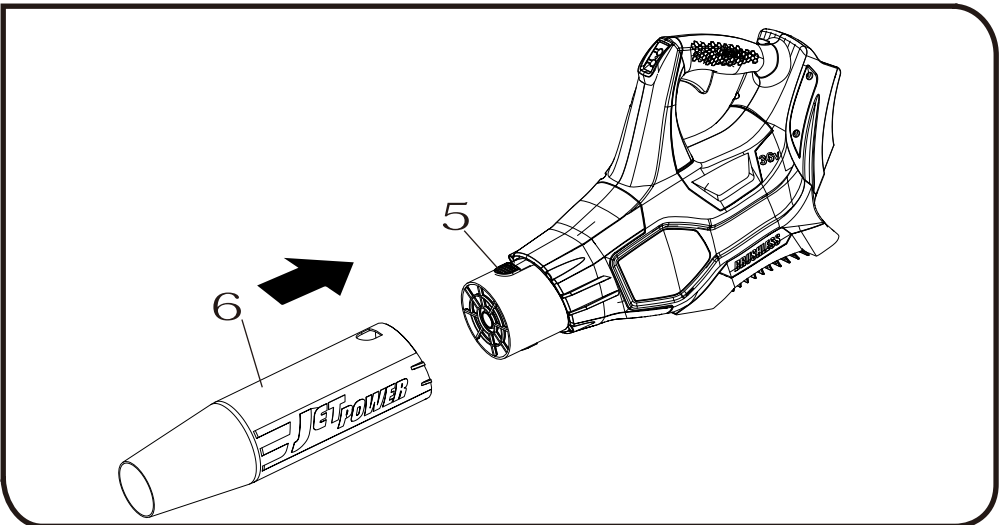

Fig. 3

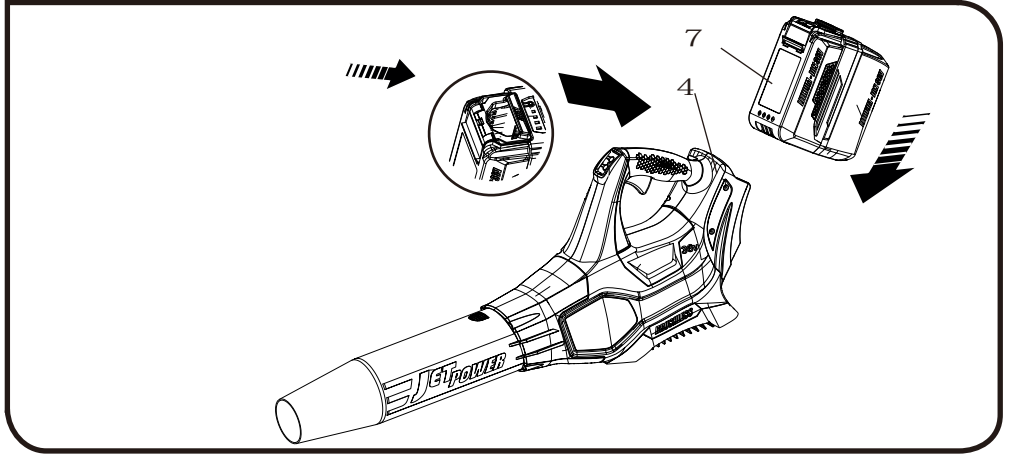

Fig. 4

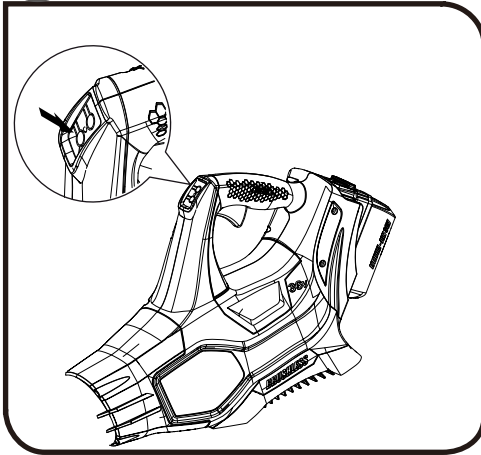

Fig. 5

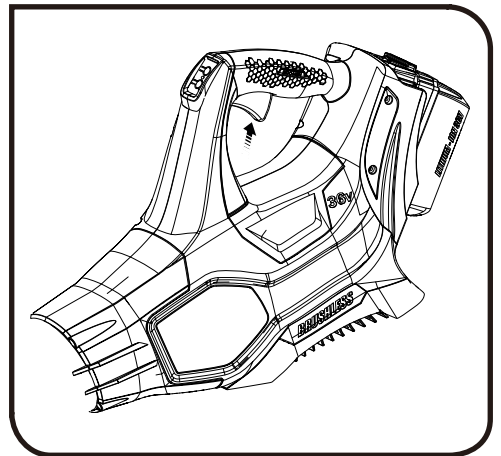
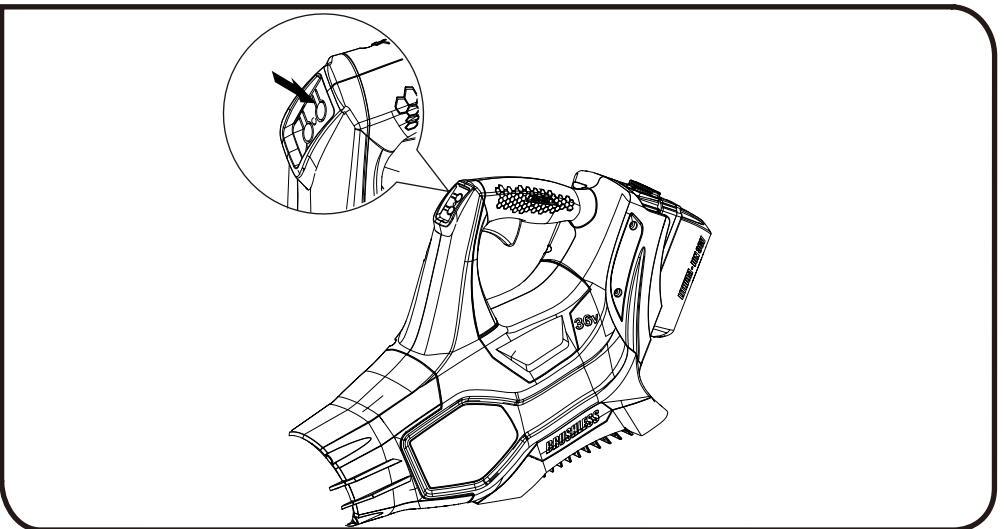

Fig. 6



Fig. 7



# Safety



## **WARNING Read all safety warnings and all instructions.**

*Failure to follow the warnings and instructions may result in electric shock, fire and/or serious injury.*

### **Save all warnings and instructions for future reference.**

The appliance is only to be used with the power supply unit provided with the appliance.

## **IMPORTANT READ CAREFULLY BEFORE USE KEEP FOR FUTURE REFERENCE**

### **Safe operating practices**

#### **1) Training**

a) Read the instructions carefully. Be familiar with the controls and the correct use of the machine.

b) Never allow children, persons with reduced physical, sensory or mental capabilities or lack of experience and knowledge or people unfamiliar with these instructions to use the machine, local regulations may restrict the age of the operator

c) Never operate the machine while people, especially children, or pets are nearby.

d) Keep in mind that the operator or user is responsible for accidents or hazards occurring to other people or their property.

#### **2) Preparation**

a) While operating the machine always wear substantial footwear and long trousers. Do not operate the machine when barefoot or wearing open sandals

Avoid wearing clothing that is loose fitting or that has hanging cords or ties.

b) Do not wear loose clothing or jewellery that can be drawn into the air inlet. Keep long hair away from the air inlets.

c) Obtain ear protection and safety glasses. Wear them at all times while operating the machine.

d) Operate the machine in a recommended position and only on a firm, level surface.

e) Do not operate the machine on a paved or gravel surface where ejected material could cause injury.

f) Before using, always visually inspect to see, that the fasteners are secure, the housing is undamaged and that guards and screens are in place. Replace worn or damaged components in sets to preserve balance. Replace damaged or unreadable labels.

#### **3) Operation**

a) Before starting the machine, make certain that the feeding chamber is empty.

b) Keep your face and body away from the feed intake opening.

c) Do not allow hands or any other part of the body or clothing inside the feeding chamber, discharge chute, or near any moving part.

d) Keep proper balance and footing at all times. Do not overreach. Never stand at a higher level than the base of the machine when feeding material into it.

e) Always stand clear of the discharge zone when operating this machine.

## Safety

g) If the machine should start making any unusual noise or vibration, immediately shut off the power source and allow the machine to stop. Remove the battery pack from the machine and take the following steps before restarting and operating the machine:

- i) inspect for damage;
- ii) replace or repair any damaged parts;
- iii) check for and tighten any loose parts.

h) Do not allow processed material to build up in the discharge zone; this may prevent proper discharge and can result in kickback of material through the intake opening.

i) If the machine becomes clogged, shut-off the power source and remove the battery pack from the machine before cleaning debris

j) Never operate the machine with defective guards or shields, or without safety devices

k) Keep the power source clean of debris and other accumulations to prevent damage to the power source or possible fire.

l) Do not transport this machine while the power source is running.

m) Always disconnect the machine from the power supply (e.g. remove the battery pack from the machine)

- whenever you leave the machine,
- before clearing blockages or unclogging chute,
- before checking, cleaning or working on the machine.

n) Avoid using the machine in bad weather conditions especially when there is a risk of lightning.

### 4) Maintenance and storage

- a) Keep all nuts, bolts and screws tight to be sure the appliance is in safe working condition.
- b) Replace worn or damaged parts.
- c) Use only genuine replacement parts and accessories.
- d) Store the machine in a dry place out of the reach of children
- e) When the machine is stopped for servicing, inspection, or storage, or to change an accessory, shut off the power source, disconnect the machine from the supply and make sure that all moving parts are come to a complete stop. Allow the machine to cool before making any inspections, adjustments, etc. Maintain the machine with care and keep it clean.
- f) Store the machine in a dry place out of the reach of children.
- g) Always allow the machine to cool before storing.
- h) Never attempt to override the interlocked feature of the guard

### 5) Additional safety instructions for units with bagging attachments

Switch-off the machine before attaching or removing the bag.

## Safety

### Safety Warnings for battery pack (not included)

- a) Do not dismantle, open or shred cells or battery pack.
- b) Do not short-circuit a battery pack. Do not store battery packs haphazardly in a box or drawer where they may short-circuit each other or be short-circuited by **conductive materials**. When battery pack is not in use, keep it away from other metal objects, like paper clips, coins, keys, nails, screws or other small metal objects, that can make a connection from one terminal to another. Shorting the battery terminals together may cause burns or a fire.
- c) Do not expose battery pack to heat or fire. Avoid storage in direct sunlight.
- d) Do not subject battery pack to mechanical shock.
- e) In the event of battery leaking, do not allow the liquid to come into contact with the skin or eyes. If contact has been made, wash the affected area with copious amounts of water and seek medical advice.
- f) Seek medical advice immediately if a cell or battery pack has been swallowed.
- g) Keep battery pack clean and dry.
- h) Wipe the battery pack terminals with a clean dry cloth if they become dirty.
- i) Battery pack needs to be charged before use. Always refer to this instruction and use the correct charging procedure.
- j) Do not maintain battery pack on charge when not in use.
- k) After extended periods of storage, it may be necessary to charge and discharge the battery pack several times to obtain maximum performance.
- l) Battery pack gives its best performance when it is operated at normal room temperature ( $20\text{ }^{\circ}\text{C} \pm 5\text{ }^{\circ}\text{C}$ ).
- m) When disposing of battery packs, keep battery packs of different electrochemical systems separate from each other.
- n) Recharge only with the charger specified. Do not use any charger other than that specifically provided for use with the equipment. *A charger that is suitable for one type of battery pack may create a risk of fire when used with another battery pack.*
- o) Do not use any battery pack which is not designed for use with the equipment.
- p) Keep battery pack out of the reach of children.
- q) Retain the original product literature for future reference.
- r) Remove the battery from the equipment when not in use.
- s) Dispose of properly.

### Additional safety instructions for your Battery Charger (not included)

1. Before charging, read the instructions.
2. Do not charge a leaking battery.
3. Do not use chargers for works other than those for which they are designed.
4. Before charging, ensure your charger is matching the local AC supply.
5. For indoor use, or do not expose to rain.
6. The charging device must be protected from moisture.
7. Do not use the charging device in the open.
8. Do not short out the contacts of battery or charger.
9. Respect the polarity "+/-" when charging.
10. Do not open the unit and keep out of the reach of children.
11. Do not charge the batteries of other manufactures or ill-suited models.



## Safety

1. Ensure that the connection between the battery charger and battery is correctly positioned and is not obstructed by foreign bodies.
2. Keep battery charger's slots are free of foreign objects and protect against dirt and humidity. Store in a dry and frost-free place.
3. When charging batteries, ensure that the battery charger is in a well-ventilated area and away from inflammable materials. Batteries can get hot during charging. Do not overcharge any batteries. Ensure that batteries and chargers are not left unsupervised during charging.
4. Do not recharge non-rechargeable batteries, as they can overheat and break.
5. Longer life and better performance can be obtained if the battery pack is charged when the air temperature is between 18 ° and 24 ° . Do not charge the battery pack in air temperatures below 4.5 ° or above 40.5 ° . This is important as it can prevent serious damage to the battery pack.
6. Charge only battery pack of the same model

# Assembly and operation

## DESCRIPTION

1. Trigger
2. Turbo button
3. Lock button
4. Housing
5. Tube latch
6. Blower tube
7. Battery pack

## KNOW YOUR BLOWER

See Figure 1.

The safe use of this product requires an understanding of the information on the blower in this operator's manual as well as a knowledge of the project you are attempting.

Before use of this product, familiarize yourself with all operating features and safety rules.

## BLOWER TUBE

The blower tube can be installed on the blower without using any tools.

## ASSEMBLY

### WARNING

To prevent accidental starting that could cause serious personal injury, always remove the battery pack from the blower when assembling parts.

## ASSEMBLING THE BLOWER TUBE

See Figure 2.

- Slide blower tube over the blower housing outlet until the tube latch locks into place through the opening in the blower tube.

## OPERATION

### WARNING

Do not allow familiarity with tools to make you careless. Remember that a careless fraction of a second is sufficient to inflict serious injury.

## INSTALLING BATTERY PACK

See Figure 3.

- Place the battery pack in the blower's battery port. Align the raised rib on the battery pack with the groove in the blower's battery port.
- Make sure the latch on bottom of the battery pack snaps in place and that battery pack is secured in the blower before beginning operation.

### CAUTION

When placing battery pack in the blower, be sure the raised ribs on the battery pack align with the grooves in the top of the blower. Make sure the battery is fully seated, and it latches into place properly. Improper installation of the battery pack can cause damage to internal components.

## REMOVING BATTERY PACK

See Figure 3.

- Release the trigger to stop the blower.
- Press and hold the latch button at the bottom of the battery pack.
- Remove battery pack from the blower.

# Operation

## STARTING /STOPPING THE BLOWER

See Figure 4 and Figure 5

- To start the blower, Press the lock button and push the trigger
- To stop the blower, release the trigger.

### ⚠ WARNING

Battery tools are always in operating condition. Therefore, the operation trigger switch should always be in the OFF (released) position when not in use or carrying/ moving the tool.

## OPERATING THE BLOWER

See Figure 6.

- To keep from scattering debris, blow around the outer edges of a debris pile. Never blow directly into the center of a pile.
- To reduce sound levels, limit the number of pieces of equipment used at any time.
- Use rakes and brooms to loosen debris before blowing. In dusty conditions, slightly dampen surfaces when water is available.
- Conserve water by using power blowers instead of hoses for many lawn and garden applications, including areas such as gutters, screens, patios, grills, porches, and gardens.
- Watch out for children, pets, open windows, or freshly washed cars, and blow debris safely away.
- After using blowers or other equipment, CLEAN UP! Dispose of debris properly.

See Figure 6.

- Pressing the turbo button, the blower can be at maximum speed immediately. Releasing the turbo button will return the speed to normal

### ⚠ WARNING

When servicing use only original manufacturer's replacement parts, accessories and attachments. Use of any other parts may create a hazard or cause product damage.

Avoid using solvents when cleaning plastic parts. Most plastics are susceptible to damage from various types of commercial solvents and may be damaged by their use. Use clean cloths to remove dirt, dust, oil, grease, etc.

### ⚠ WARNING

Do not, at any time, let brake fluids, petrol, penetrating oils, etc. come in contact with plastic parts. They contain chemicals that can damage, weaken or destroy plastic.

### ⚠ WARNING

Do not attempt to modify this tool or create accessories not recommended for use with this tool. Any such alteration or modification is misuse and could result in a hazardous condition leading to possible serious personal injury.

### ⚠ WARNING

To avoid serious personal injury, always remove the battery pack from the tool when cleaning or performing any maintenance.

## STORING THE BLOWER

Clean the blower thoroughly before storing. Store the blower in a dry, well-ventilated place that is inaccessible to children. Keep away from corrosive agents such as garden chemicals.

- Store and charge your batteries in a cool area. Temperatures above or below normal room temperature will shorten battery pack life.
- Never store batteries in a discharged condition. Wait for battery pack to cool and fully charge immediately.
- All batteries gradually lose their charge. The higher the temperature, the quicker they lose their charge. If you store your unit for long periods of time without using it, recharge the batteries every month or two. This practice will prolong battery pack life.

## ENVIRONMENTAL PROTECTION



Recycle raw materials instead of disposing of as waste. The machine, accessories and packaging should be sorted for environmental-friendly recycling.

# Symbols

## SYMBOLS

Some of the following symbols may be used on this product. Please study them and learn their meaning. Proper interpretation of these symbols will allow you to operate the product better and safer.



Safety alert

Please read the instructions carefully before starting the machine.



Do not expose to rain or damp conditions.



Wear ear and eye protection.



Beware of thrown or flying objects. Keep all bystanders at least 15 m away.



Failure to keep long hair away from the air inlet could result in personal injury



Failure to keep loose clothing from being drawn being drawn into air intake could result in personal injury



Rotating impeller blades can cause severe injury



Remove the battery before servicing



The guaranteed sound power level is 100 dB



Waste electrical products should not be disposed of with household waste. Please recycle where facilities exist. Check with your Local Authority or retailer for recycling advice.

## PRODUCT SPECIFICATIONS

### Cordless Blower

Model	LB4020001S	
Motor	40 V	
Air Velocity	216 km/h	
A-weighted sound pressure level	87.0 dB(A)	
A-weighted sound power level	100 dB(A)	
Uncertainty	KPA =3.0 dB(A)	
Vibration emission value	<2.5 m/s <sup>2</sup>	
Uncertainty	K = 1.5 m/s <sup>2</sup>	
Air Volume	13 m <sup>3</sup> /min	
Weight (without battery)	2.4 kg	
Battery Pack	LB40B	Not included
Charger	LB40BCKT	Not included

## GUARANTEE

This product has a 3 year guarantee. This guarantee is only valid if the product has not been used correctly and all the instructions have been followed.

In order to prove guarantee a receipt must be presented. The product has to be complete and have all its parts.

The guarantee does not cover wear, lack of maintenance, negligence, incorrect assembly and inappropriate usage (blows, disrespect to power supply, storage, using conditions, etc).

It is also void when non original accessories or parts, have been used on the product.